

etzMAN – OPERATION GUIDE

Simplicity is the
soul of Efficiency

Austin Freeman

ETZINGER AG

Wirtschaftspark 44

FL-9492 Eschen

Phone: +423 375 8383

www.etzinger-ag.com

support@etzinger-ag.com



etzMAN Basic



etzMAN-W

The etzMAN is a manual tabletop Coffee Grinder that may be used to grind whole, roasted beans.

DELIVERY CONTENT:

Grinder complete with Hopper 200g
Crank Handle
Portafilter Holder
Adjustment with AP-cone
Glove / 2 Brushes

etzMAN-W only:

3 AA-batteries

1. Hopper
2. Portafilter Holder
3. Crank Handle
4. Adjustment
5. Operating your etzMAN (basic)
6. Programming your etzMAN-W
7. Operating your etzMAN-W
8. Calibrate your etzMAN-W
9. Batteries (etzMAN-W)
10. Cleaning your etzMAN
11. Safety Instructions

DISCLAIMER OF LIABILITY

ETZINGER AG will not accept any liability for damage, injury or warranty if the grinder is used other than for its intended purpose, the grinding of roasted whole coffee beans, or is improperly operated or repaired.

Please note: etzMAX and etzMAN are based on the same modular concept. Pictures showing cleaning/adjusting instructions may be used likewise.

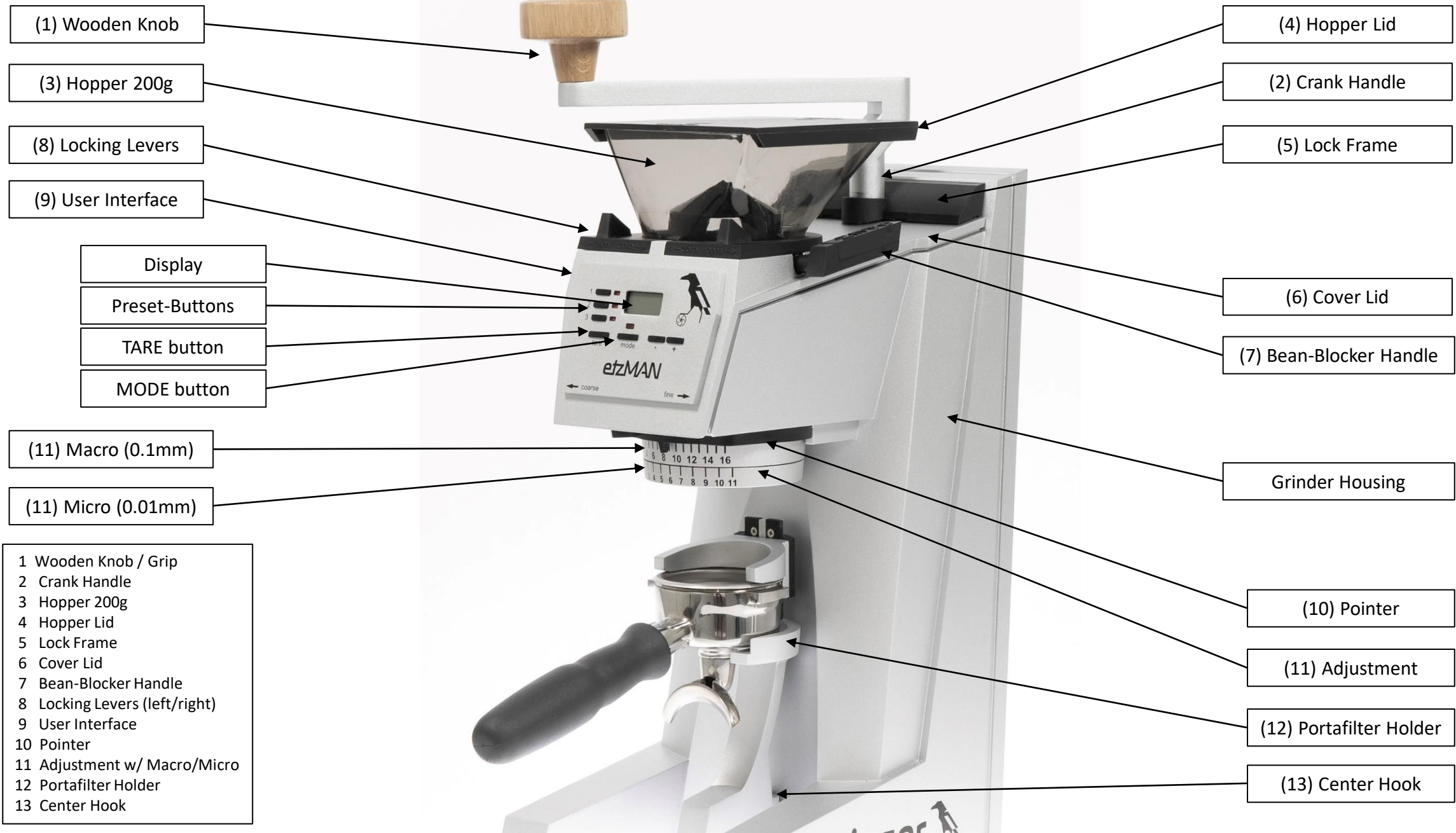

(1) Wooden Knob

(3) Hopper 200g

(8) Locking Levers

(9) User Interface

Display

Preset-Buttons

TARE button

MODE button

(11) Macro (0.1mm)

(11) Micro (0.01mm)

- 1 Wooden Knob / Grip
- 2 Crank Handle
- 3 Hopper 200g
- 4 Hopper Lid
- 5 Lock Frame
- 6 Cover Lid
- 7 Bean-Blocker Handle
- 8 Locking Levers (left/right)
- 9 User Interface
- 10 Pointer
- 11 Adjustment w/ Macro/Micro
- 12 Portafilter Holder
- 13 Center Hook

(4) Hopper Lid

(2) Crank Handle

(5) Lock Frame

(6) Cover Lid

(7) Bean-Blocker Handle

Grinder Housing

(10) Pointer

(11) Adjustment

(12) Portafilter Holder

(13) Center Hook

GETTING STARTED

Carefully unpack grinder and verify delivery contents according to attached list. Clean all loose parts with a soft damp cloth and allow to dry completely before use.

1. HOPPER

INSTALLING BEAN HOPPER (3) / SINGLE DOSING CAP

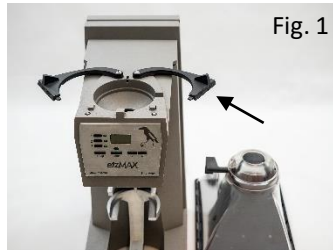

Fig. 1

Push both locking levers (8) rearwards (arrow direction OPEN, Fig. 1).

Position hopper (bean-blocker handle (7) to the right) at intended opening.



Fig. 2

Close locking levers and rotate bean-blocker by 180° into OPEN-position (Fig. 2).

Fill in the beans and close lid (4).

NOTE:

To easily fill in beans (without having to pull off the crank handle), just flip around the lid (4) and slide it onto the hopper from the front.

NOTE: Hopper should be cleaned daily as coffee oil residues can have a negative effect on the taste of your coffee. Once empty and removed (acc. to our instructions), hopper and lid may be washed in warm soapy water. Rinse and dry thoroughly.

REMOVING BEAN HOPPER (3) / SINGLE DOSING CAP

Close bean-blocker handle by turning it to the front. Open locking levers. Lift off hopper and place it on its lid.

2. PORTAFILTER HOLDER (12) - Espresso) / PLATFORM (Filter)

Use your index finger to press against the rear part part of the upper holding arm (Fig. 3/4) while sliding the arm in position with your thumb – up/down (Fig. 5).



Fig. 3



Fig. 4



Fig. 5



Fig. 6

Once adjusted, insert the portafilter holder / platform (Fig. 7) onto the center hook (13) and **slide it rearwards as far as it will go** (Fig. 6).



Fig. 7

3. INSTALLING CRANK (2)

Position and insert crank at respective outlet. Ensure for it to be locked into place.

4. ADJUSTMENT (11)

The Adjustment (Fig. 8) consists of a stepped macro adjust and a stepless micro adjust.

Recommended settings (final setting depends on roast&brand; coarser settings for lighter roasts)

Ristretto / Espresso / Longhi Macro 4-8 / 6-10 / 8-12 Micro 1

Fig. 8

The macro adjust includes 16 steps (à 0.1mm).

To move from **coarse (16)** to **fine (1)**, turn the macro- (top) ring to the right (Direction FINE).



To move from fine to coarse, turn the macro ring to the left (Direction COARSE).

The pointer (10) indicates your macro-setting. **The micro adjust** (bottom ring) ranges from coarse (11) to fine (1) steplessly (0.01mm) and allows for even more precise grind settings (**Click 1 on macro ring serves as reference point for the micro ring**).

5. USING / OPERATE your etzMAN (basic)

Before using your etzMAN, make sure for the Bean-Blocker-Handle to be in OPEN position (if operated with Hopper).

Insert Portafilter and start rotating the handle.

Use the enclosed cloth/glove (Delivery Content) to protect the grinders' surface when grinding and for a more comfortable grip.

Use AP-cone for traditional roasts or Pour Over, use ETZI-cone for lighter roasts.

6. PROGRAMMING your etzMAN-W

The etzMAN User Interface (9) is equipped with three programmable buttons labeled 1, 2 and 3 (Fig. 9). These buttons adjust the grind weight in grams but not the grind setting (Coarse/Fine).

Fig. 9



To change the setting, proceed as follows:

1. Select a **Preset** button (1, 2, 3)
2. Press **+** or **-** to program the weight (in grams)
3. Once the desired weight setting in grams is reached, press and hold the selected button for **3 seconds**. The display will flash to confirm the setting and you will hear a confirmation sound. Repeat steps 1-3 to program the other buttons.

7. USING / OPERATE your etzMAN-W

Before using your etzMAN, make sure for the Bean-Blocker-Handle (7) to be in OPEN position (if operated with Hopper).

Press MODE to wake up grinder followed by the desired **Preset-button** (1, 2, 3). Display will show the programmed weight in grams. **Press TARE** and insert portafilter. Before starting to grind, **press MODE once more**. Turn the crank counter-clockwise and hold on to the upper backside of the grinder to ensure stability. While grinding, the display will show the corresponding weight in grams. When drawing closer to the target weight, an acoustic alert will be heard. Once the target weight is reached, the sound will be nonstop.

Use the enclosed cloth/glove (Delivery Content) to protect the grinders' surface when grinding and for a more comfortable grip.

Use AP-cone for traditional roasts or Pour Over, use ETZI-cone for lighter roasts.

8. CALIBRATE your etzMAN-W

After moving it or in case of inconsistencies, we recommend to recalibrate your etzMAN-W as follows (weight is not part of the delivery content):

Take off Hopper and Portafilter Holder as described, then press MODE to wake up Grinder. **Turn Adjustment to the left** (clockwise, vs COARSE) beyond Click 16 until Display turns itself off, then move it back to 16. **Press 1 and MODE** simultaneously until the screen turns on, **keep on pressing 1** only until CAL appears.

Place 500g Calibration Weight onto the center hook, then press MODE for at least 3 seconds before letting go (500 will blink and then show End, followed by your setting). Remove weight, press MODE and reposition weight on center hook to confirm weight (500g). Press TARE to return to normal mode.

9. BATTERY – Replacing the battery on the etzMAN-W

For operation, the User Interface requires 3 AA-batteries that need to be replaced when reaching the end of their life-span.

Turn Bean-blocker Handle in closed position, open Locking Levers (8) – left and right - and remove Hopper. Remove Crank Handle by pulling it off.



Fig. 10

Remove Pointer (10) by undoing the screws on its left/right side (Fig. 10, Torx 25). Remove Lock Frame (5) by slightly lifting and pressing upwards. Use Torx 10 to release both screws beneath. Open Cover Lid (6), Fig. 11, the Battery Case is positioned on its back side (Fig. 12).

Take off Phillips-screw and open case cover. Replace batteries (3AA – Fig. 13) and reassemble in reverse order.

Observe regulations in respective countries when disposing off used batteries.



Fig. 11

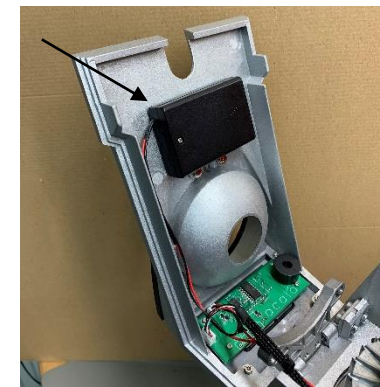

Fig. 12



Fig. 13

10. CLEANING the etzMAN

Cleaning Schedule: We recommend cleaning on a regular basis (after having ground around 1-2kg)

Rotate bean-blocker handle (7) from OPEN to the front. Insert portafilter / place cup and clear grinding chamber by grinding until empty (8.5g). Remove portafilter.

Push both locking levers (8) backwards as far as they will go. Lift off hopper (ensure lid is closed) and place aside (Fig. 1). Close both locking levers. To remove portafilter holder, pull it off the hook. Mark down settings!



Remove adjustment (11) by turning the macro-ring counterclockwise (Fig. 15) until you feel no more resistance. Slowly pull it downwards and out (Fig. 16).

To clean grinding chamber, insert bottlebrush from above through the hopper opening. Use small brush to clean the cone holder. If removing cone holder for cleaning, ensure it's perfectly snapped in when reassembling.

NOTE: To remove remaining coffee powder (stuck in between the sealings), occasionally (after cleaning) turn macro ring to finest setting (Click 1) and back to your settings.



Reassemble adjustment in reverse order (reposition at 8 o'clock, see marking before mounting, Fig. 17).

Once snapped in properly, turn and return to your previous settings. Insert portafilter holder / platform onto center hook.

Open locking levers (Fig. 1), place back hopper and close locking levers (Fig. 2). Carefully rotate bean-blocker handle all the way to the back to OPEN position (Fig. 2).

In case of questions/issues, contact your Reseller or send an email to support@etzing-ag.com!

11. SAFETY INSTRUCTIONS

Please read the information below very carefully. It contains important safety information for this grinder. Please keep these instructions for future reference.

- ✓ **Only use the grinder for its intended purpose, the grinding of roasted whole coffee beans.**
- ✓ Ensure for the grinder to be set up on a smooth surface for maximum stability.
- ✓ Make sure to stabilize grinder while rotating the handle.
- ✓ This grinder can be used by children aged from 8 years and above and persons with reduced physical, sensory or mental capabilities or lack of experience and knowledge if they have been given supervision or instruction concerning use of the grinder in a safe way and understand the hazards involved.
- ✓ Avoid for the burrs to get in contact with water.
- ✓ **Cleaning and user maintenance** shall not be made by children without supervision by a qualified person. **Maintenance and repair work** to be carried out by manufacturer, its service agent or qualified persons only.
- ✓ Dispose of batteries according to regulations in respective country (etzMAN-W only).